

## Sockets for RSLM Relays

### ZRLS1 NA

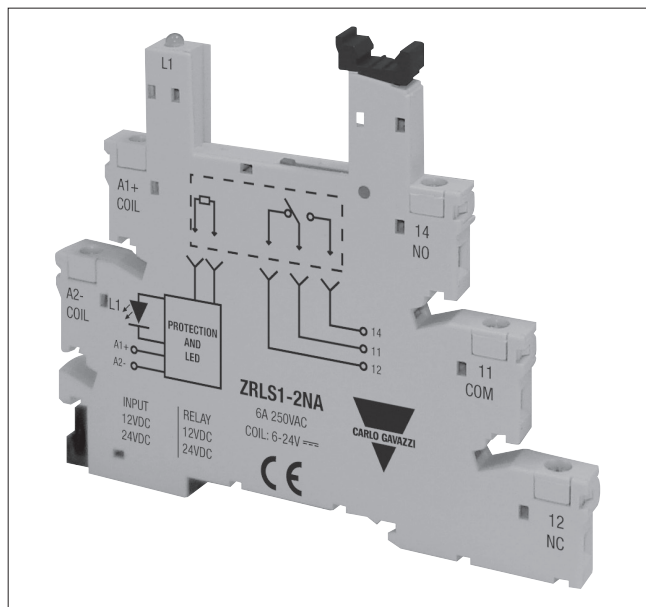

### mm/inches DIMENSIONS

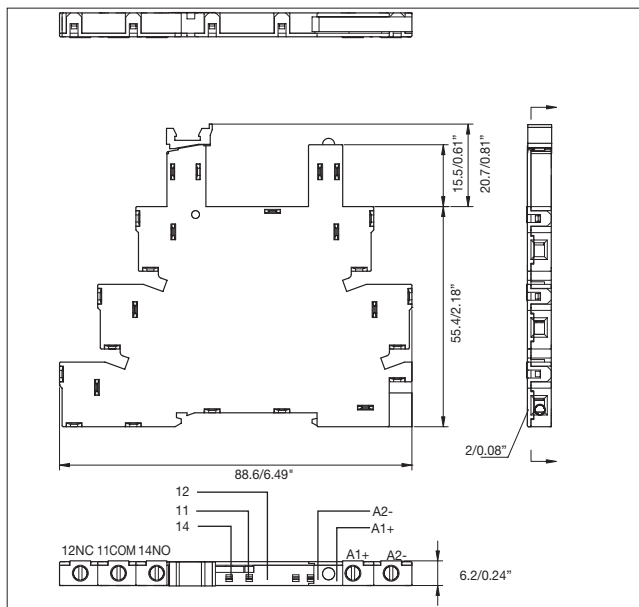

### General Data

Rated voltage	250VAC
Rated current	6A
Insulation voltage	>3kV
Protection degree	IP 20 B
Socket material	PA66+GF (V0)
Socket colour	RAL 7035 / Pantone 1C
Contacts material	CuSN 6.5-0.1
Contacts surface	Tin-plated
Terminal type	Screw cage
Operating temperature	-40° to +70°C (-40 to 158°F)
Max wire section	
Flex / Compact wire	2 x 2.5mm (14AWG)
Cable End	2 x 1.5mm (16AWG)

### Input data and Ordering code

<b>ZRLS1-2NA</b>	
Input	6 to 24VAC/VDC
Coil rate*	6 to 24VDC
<b>ZRLS1-3NA</b>	
Input	48 to 60VAC/VDC
Coil rate*	48 to 60VDC
<b>ZRLS1-4NA</b>	
Input	110 to 125VAC/VDC
Coil rate*	60VDC
<b>ZRLS1-5NA</b>	
Input	220 to 240VAC/VDC
Coil rate*	60VDC

\* The coil rate value is the socket output voltage. The relay to be fitted should have the same coil voltage.

### Output Data

Max voltage	300VAC max
Max current	6A

### Approvals



Box content:	20 sockets
Box size:	(W 15 x D 8.5 x H 9.5) mm
Weight:	600g
	(W 0.59 x D 0.33 x H 0.37) inches
Weight:	21.16oz

### Optional Accessories (to be ordered separately if required)

Labels	ZRLS-LAB
Separator	ZRLS-DIV
Bridging bar	ZRLS-BB